

Memorial Program/Dove Release/Picnic

Saturday, September 29th

Lake Shawnee, Shelterhouse #3

3616 SE Memory Point off West Edge Road



The Topeka Chapter of TCF will be holding its 25th Annual Memorial Program/Picnic/Dove Release on Saturday, September 29, 2018. We will gather at Shelterhouse #3 at Lake Shawnee (map on reverse side). This facility has both outdoor and indoor seating, air conditioning, full kitchen facilities and restrooms. Please note the date change for this year's event - it will be the **fifth Saturday** of September and will **take the place** of our regular September support group meeting. We will begin gathering at 11:30 am for a social time, with the potluck dinner planned for noon. The Memorial Program will begin at 1:35 p.m. with the Dove Release scheduled for approximately 2:15 p.m. We are excited to have **singer/songwriter** Alan Peterson with us to perform a special musical program. We sincerely hope you and your family will plan on joining us as we celebrate the lives of our beloved children, grandchildren and siblings.

For the picnic the Topeka TCF Chapter will provide the meat course, rolls, margarine, ice tea, lemonade and table service. We ask each family attending to bring a salad, a vegetable and/or a dessert to share. Please remember to bring serving utensils. You are encouraged to bring lawn chairs to sit outdoors if the weather is mild. Dress is casual. In the event of inclement weather, the Dove Release will be rescheduled, but the Memorial Program and the Potluck Picnic will take place as scheduled.

To help cover the Chapter's expenses for this event, we are offering you the opportunity to Sponsor a Dove in loving memory of your child, grandchild or sibling. Cost to sponsor a dove is just \$5.00. If you wish to do so, please indicate on the form below and return a check for \$5.00 for each dove sponsored with your RSVP Form (make checks payable to The Compassionate Friends). Dove Sponsorships will be listed in the memorial program.

In order to plan for the event, we need to know how many of you would like to attend. Please fill out the form below and return **by September 22nd** Send to: Susan Chan, 3448 S.W. Mission Ave., Topeka, KS 66614-3629.

Picnic RSVP/Dove Sponsorship Form

(Please return by September 22nd)

YES, please count on me/we attending the Memorial Program/Picnic/Dove Release on Saturday, September 29, 2018

There will be _____ adults and _____ children from our family.

We will plan to bring (please circle **one or more** of the following) SALAD VEGETABLE DESSERT

We would also like to Sponsor a Dove in memory of _____

We have enclosed \$5.00 for each Dove Sponsorship - Total enclosed \$ _____

Name _____

Address _____

Phone# _____ Email _____

We Look Forward To Seeing You On September 29th!

Send to: Susan Chan, 3448 S.W. Mission Ave., Topeka, KS 66614-3629

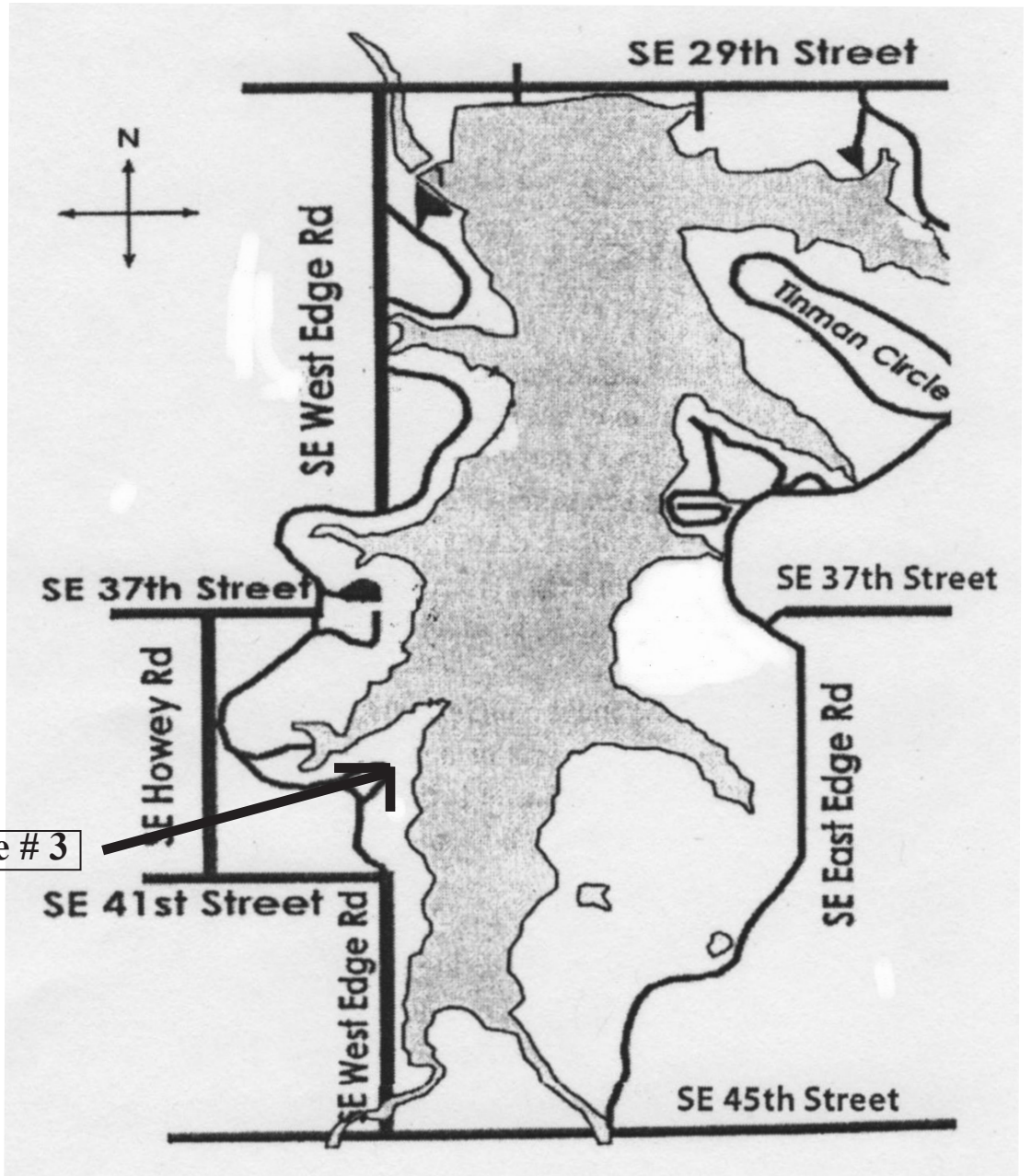

Shelter House # 3